

TAPESTRY TOOL beta

Multi-Content Nodes and Tapestries



THE UNIVERSITY
OF BRITISH COLUMBIA



Microsoft

HOW TO CREATE A MULTI-CONTENT NODE

Multi-content nodes can be used by tapestry authors to incorporate linearity into the non-linear structure of Tapestry Tool.

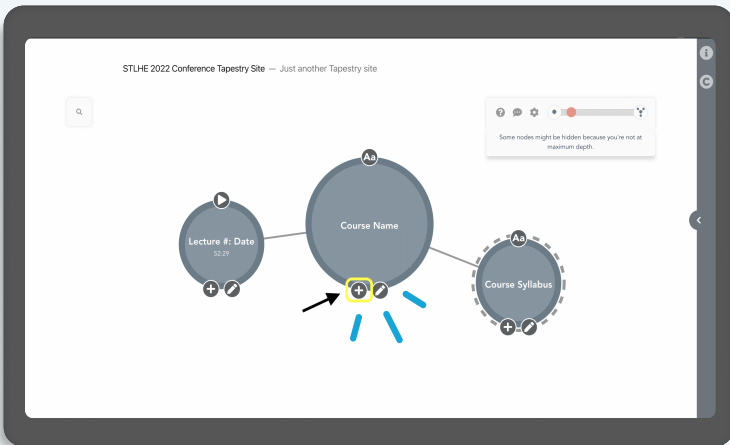

- 1 Press the plus button beneath a node.
- 2 Press the drop-down menu under “Content Types” and choose the “Multi-Content” content type.
- 3 Right away, press the “Save” button under “Sub-Items.”

- 4 Next, press the drop-down menu under “Presentation Types” to choose how your content will be displayed to viewers.

- **Accordion:** Displays content linearly in a drop-down menu.
- **Page:** Displays content one after the other in a single page.
- **Unit:** Displays a collection of multi-content pages, accompanied by a table of contents. See the next page to learn more about units.

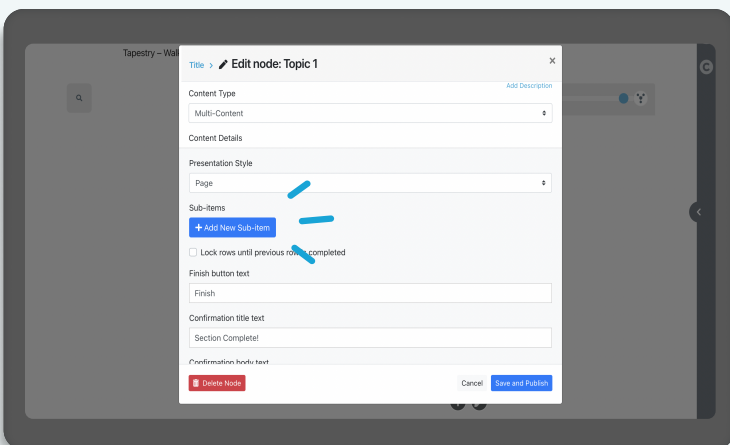
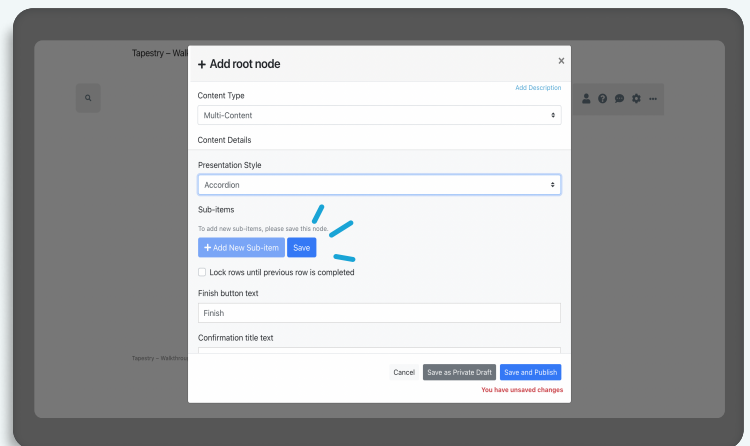

- 5 After, you can press the “Add New Sub-Items” button under “Sub-Items” and start populating this panel with content (see “How to Add Your First Node”).

- 6 Press “Save and Publish” after creating your node to save this as a sub-item of your multi-content node.

- 7 After you have finished adding all of your sub-topics, press the “Save and Publish” button under the multi-content node to publish it.

HOW TO CREATE A MULTI-CONTENT UNIT

Multi-content units are linear modules created within the non-linear Tapestry Tool authoring tool.

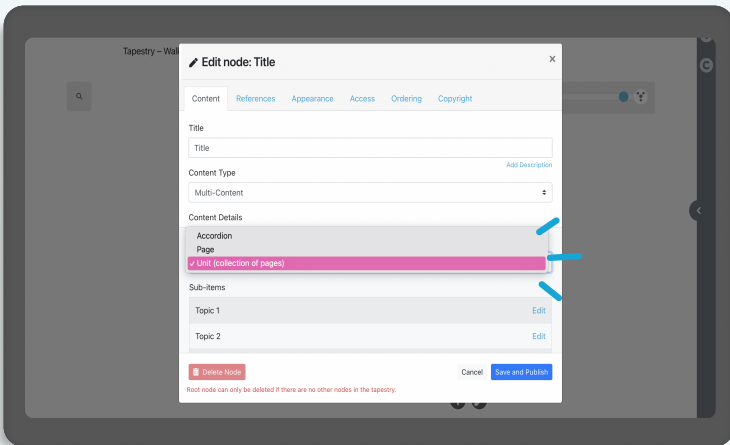

- 1 Follow the instructions on the previous page for creating a multi-content node.
- 2 Under “Presentation Style,” choose the “Unit” content type.
- 3 Press the “Save” button under “Sub-Items,” then press the “Add New Sub-Items” button to create your next multi-content node.

- 4 After creating your new multi-content node (see the previous page for more instructions), navigate to the “Appearance” tab and select the “Open content in full screen” and “Add navigation bar” buttons.

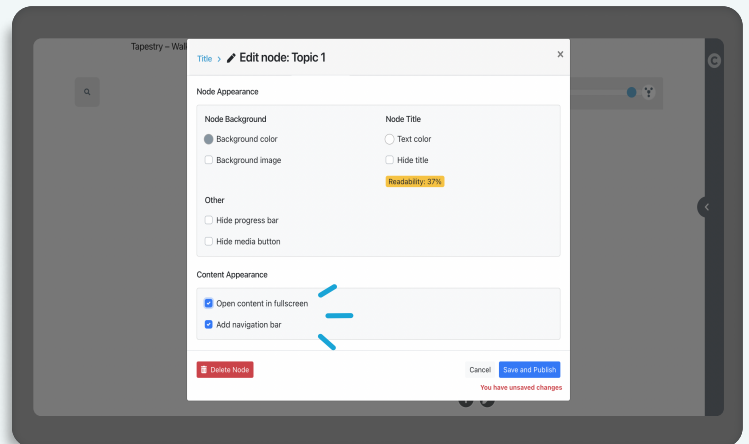

- 5 Finally, press “Save and Publish” under every node to ensure that your content is saved.
- 6 You can view your new multi-content unit by opening the first/root node in your tapestry.

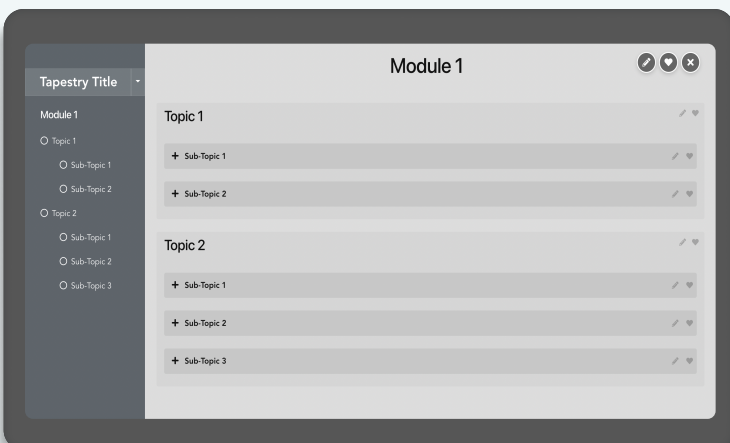

Note: Nodes (besides the root node) on the page will not be visible for users who are not logged in.

TIPS FOR CREATING MULTI-CONTENT NODES



Colour code the nodes in your tapestry to improve you and your colleagues' navigation of the tapestry while authoring (see "Changing a Node's Appearance"). For example, colour each module a particular colour so they are easily distinguishable.



Use the "Page" and "Accordion" Presentation Types to present multiple pieces of content to users, without overwhelming them with many nodes.

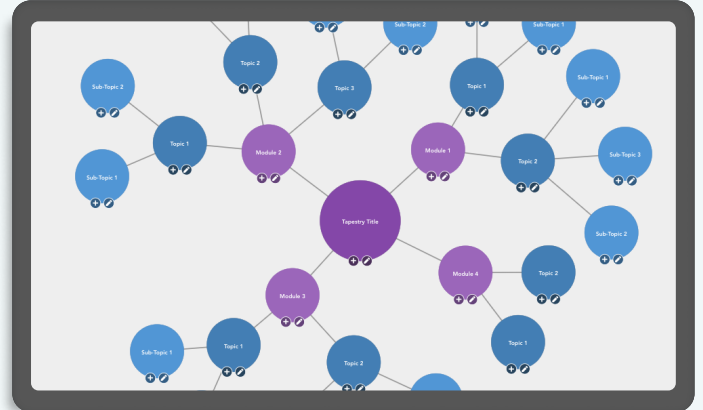

When sharing your multi-content tapestry with users, make sure to copy the link of the module once you have opened the content itself. That way, users will land on the opened module as soon as they enter the tapestry.

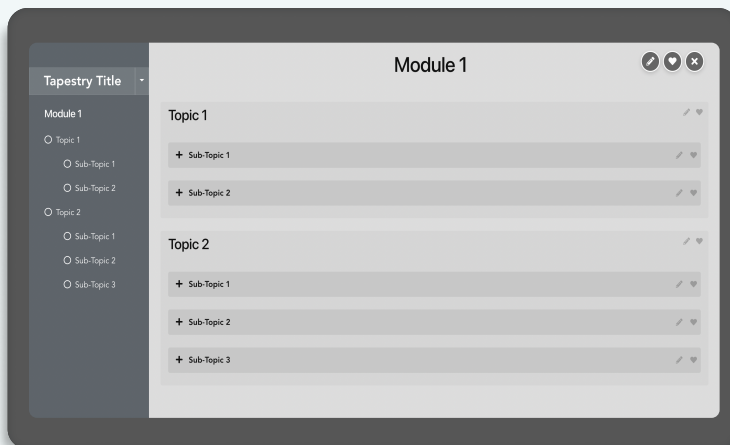

Consider creating a module or node in your multi-content tapestry that is dedicated to explaining how you would like users to navigate the modules you have developed. For instance, if you would like users to complete activities at a particular point in their learning sequence, then make sure to denote this here.



Interested in developing multi-content nodes? Don't know where to start? Reach out to us at info@tapestry-tool.com to learn more and receive a template for developing a multi-content node or module!